

REF	FERRAGENS	QTD
A	8 x 30 mm	24
B	10 x 10 mm	30
C	Parafuso Minifix	04
D	Tambor Minifix	04
E	5 x 50 mm	06
F	4 x 16 mm	08
G	4 x 14 mm	56
H	Puxador	02
I	Cantoneira Plástica	18
J	Sapata Plástica	04
K	Corrediça Telescópica	02
L	Tampa adesiva	14

Lista de peças

CÓD	DESCRIÇÃO	QTD	DIMENSÕES
01	Lateral Direita	1	585 x 385 x 15
02	Lateral Esquerda	1	585 x 385 x 15
03	Tampo	1	450 x 400 x 15
04	Base / Tampo Nicho	2	420 x 385 x 15
05	Frente Gaveta	2	440 x 165 x 15
06	Laterais Gaveta	4	350 x 100 x 15
07	Traseiro Gaveta	2	315 x 100 x 15
08	Rodapé	1	420 x 50 x 15
09	Costas	1	550 x 450 x 3
10	Fundos Gaveta	2	345 x 350 x 3

FERRAMENTAS NECESSÁRIAS:

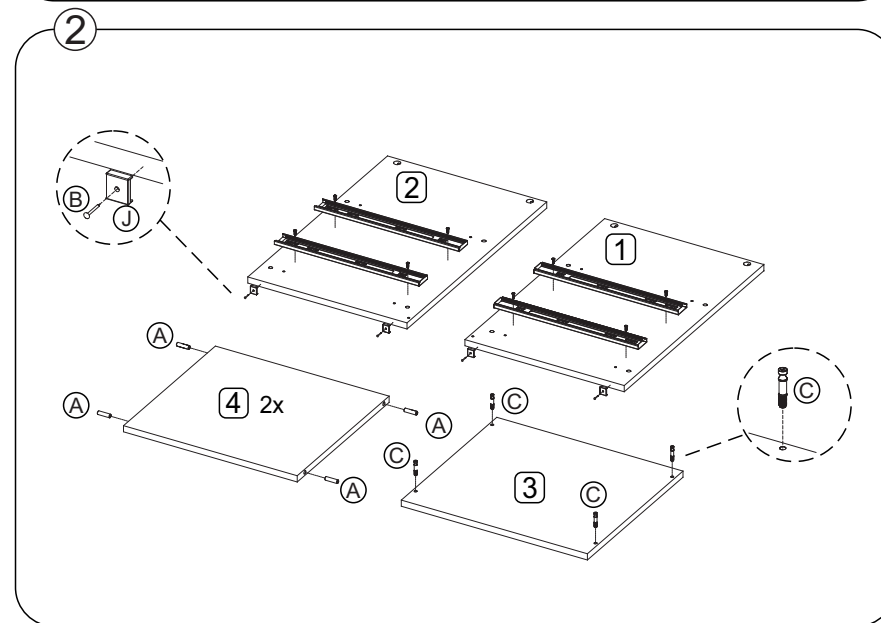
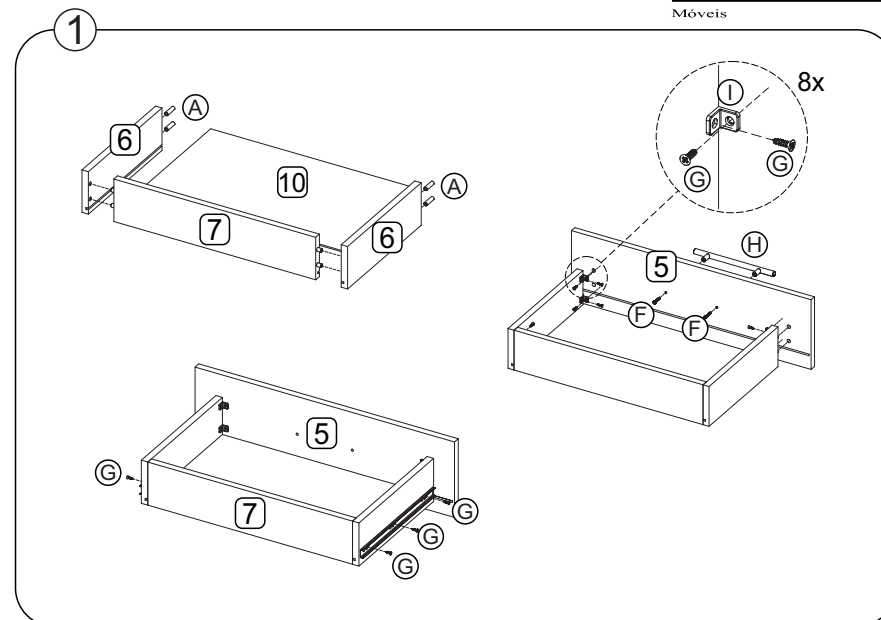

Data: 20/04/2026 Revisão: 00

"IMPORTANTE LER COM ATENÇÃO E GUARDAR PARA EVENTUAIS CONSULTAS"

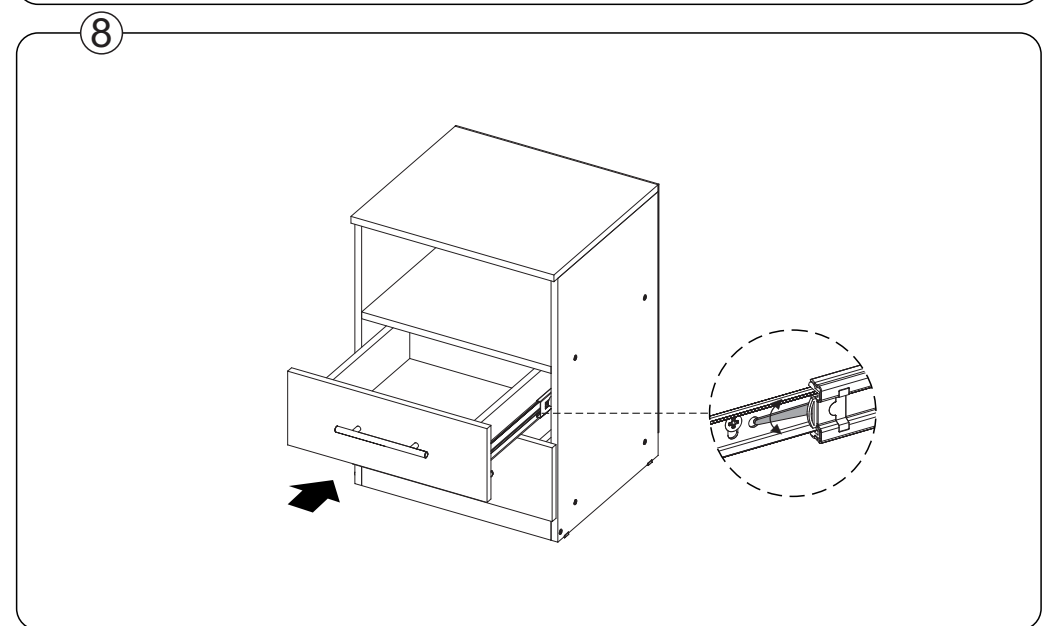
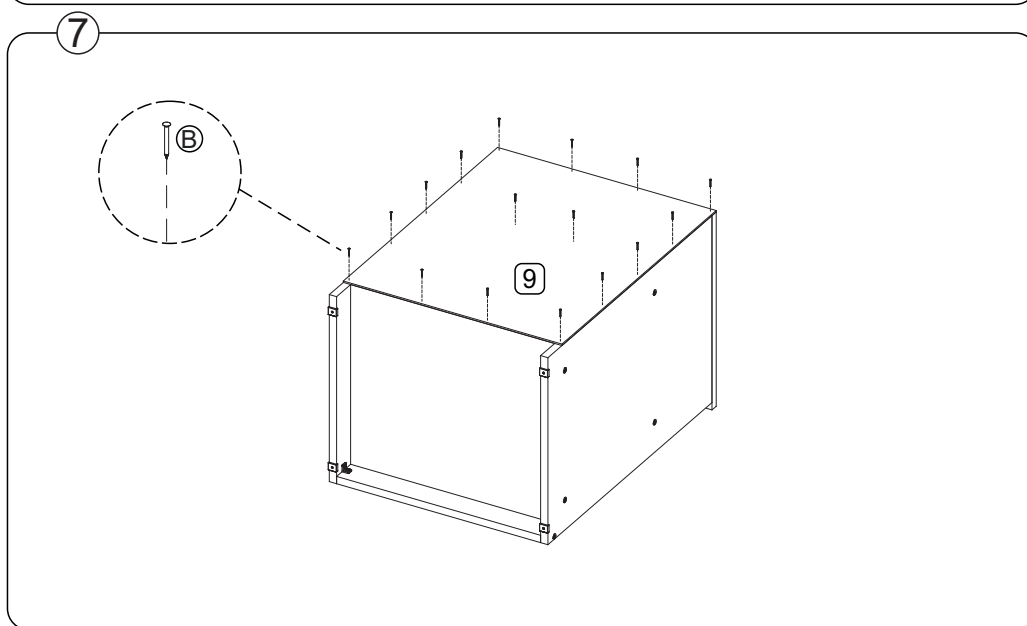
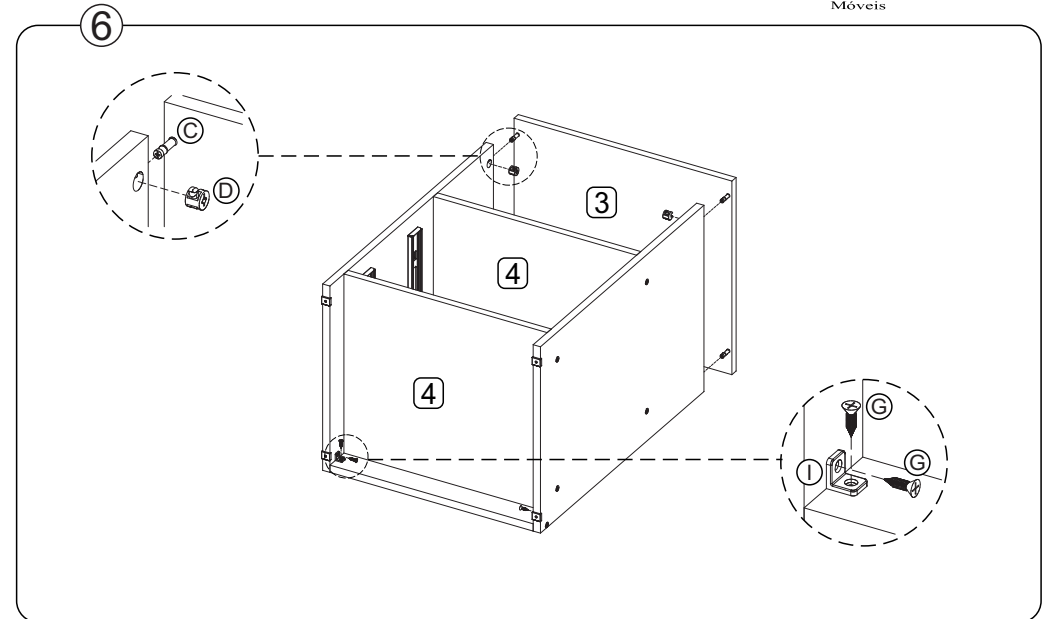
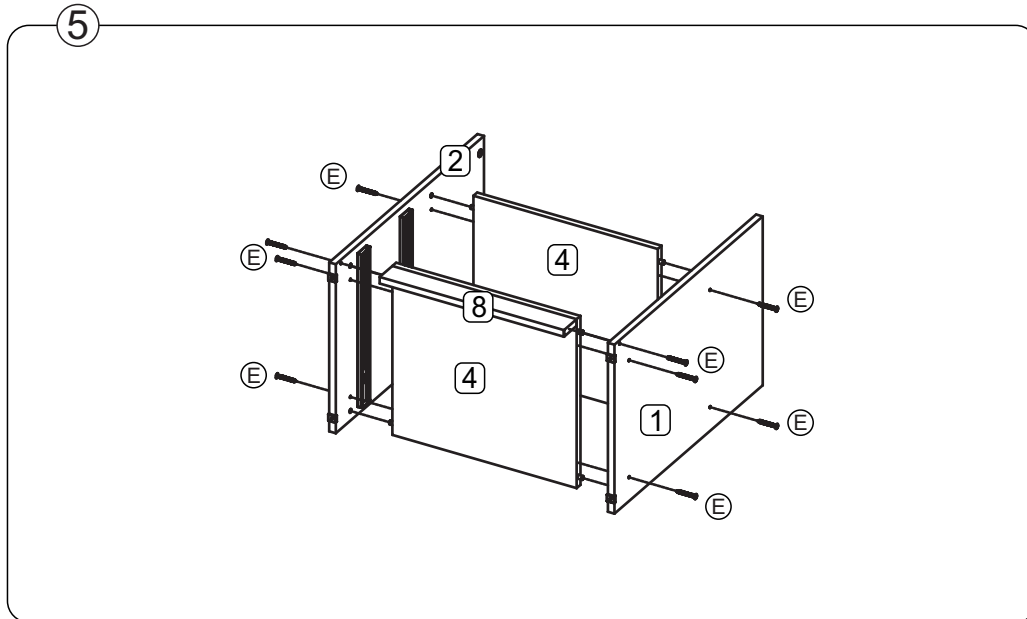

"IMPORTANTE LER COM ATENÇÃO E GUARDAR PARA EVENTUAIS CONSULTAS"