



REF	FERRAGENS	QTD
A	8 x 30 mm	36
B	10 x 10 mm	30
C	Parafuso Minifix	04
D	Tambor Minifix	04
E	5 x 50 mm	06
F	4 x 16 mm	08
G	4 x 14 mm	116
H	Puxador	04
I	Cantoneira Plástica	34
J	Sapata Plástica	04
K	Corrediça Telescópica	04
L	Tampa adesiva	15
M	Perfil H	01

Lista de peças

CÓD	DESCRIÇÃO	QTD	DIMENSÕES
01	Lateral Direita	1	785 x 395 x 15
02	Lateral Esquerda	1	785 x 395 x 15
03	Tampo	1	610 x 410 x 15
04	Base	1	580 x 395 x 15
05	Frente Gaveta	4	600 x 175 x 15
06	Laterais Gaveta	8	350 x 100 x 15
07	Traseiro Gaveta	4	475 x 100 x 15
08	Rodapé	1	580 x 50 x 15
09	Costas	2	750 x 300 x 3
10	Fundos Gaveta	4	505 x 350 x 3

FERRAMENTAS NECESSÁRIAS:

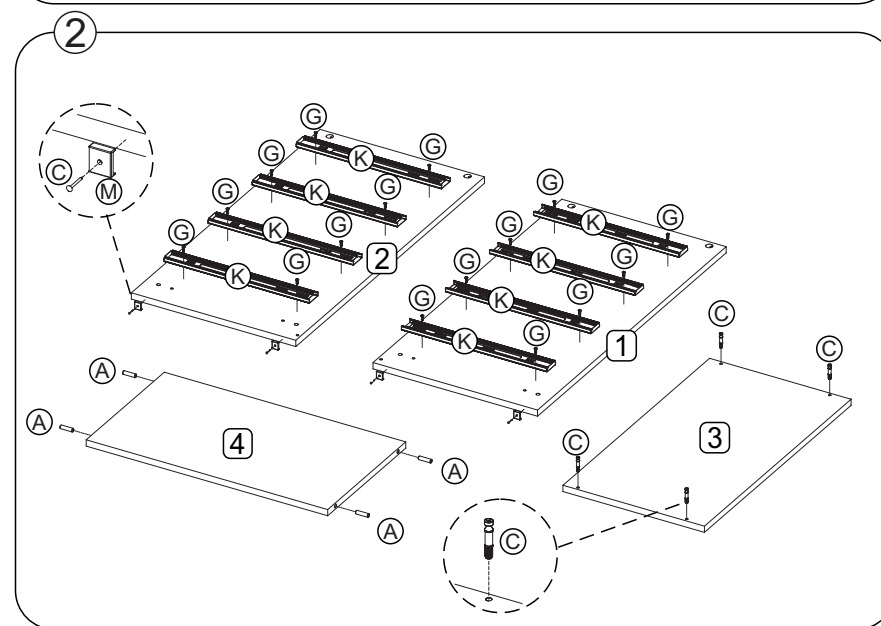
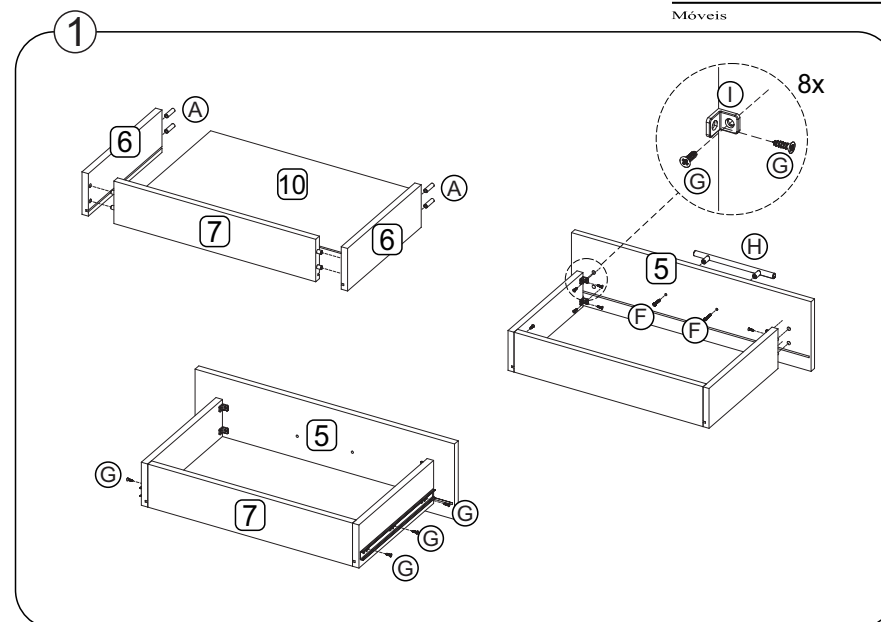

Data: 20/04/2026 Revisão: 00

"IMPORTANTE LER COM ATENÇÃO E GUARDAR PARA EVENTUAIS CONSULTAS"

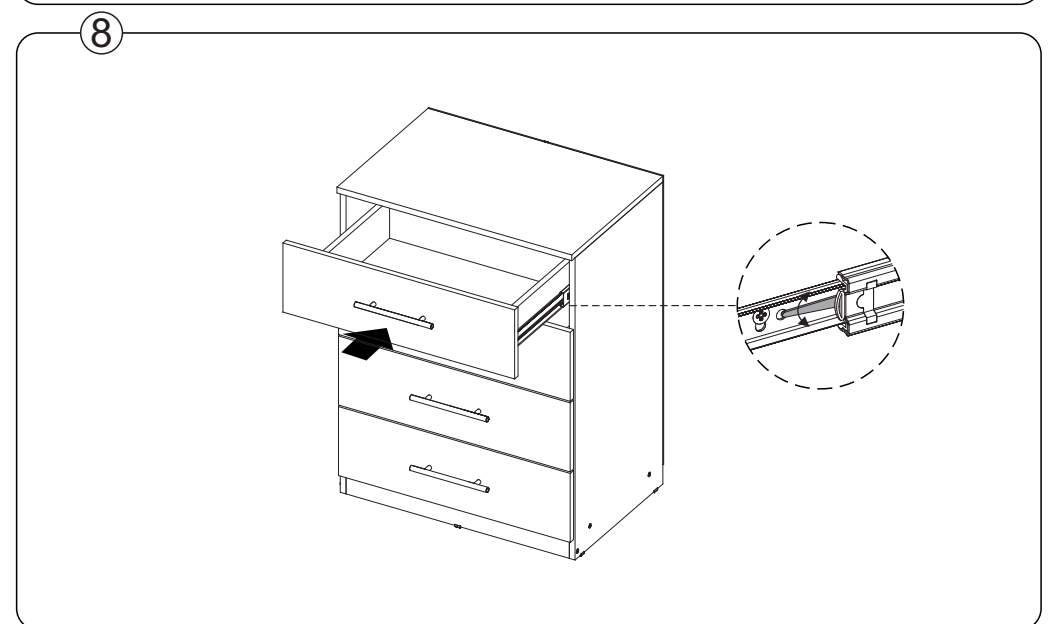
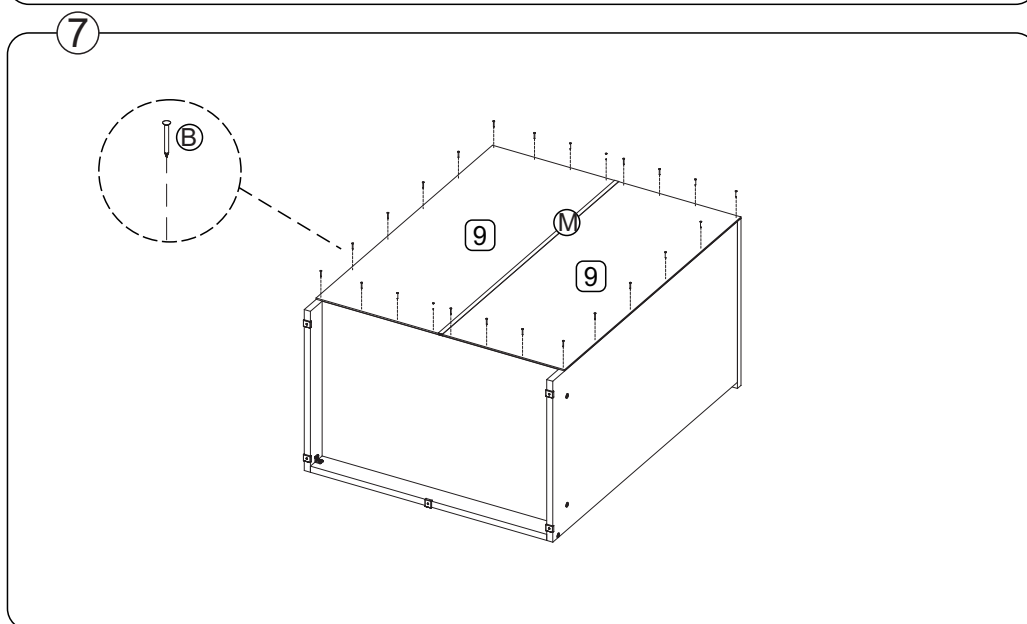
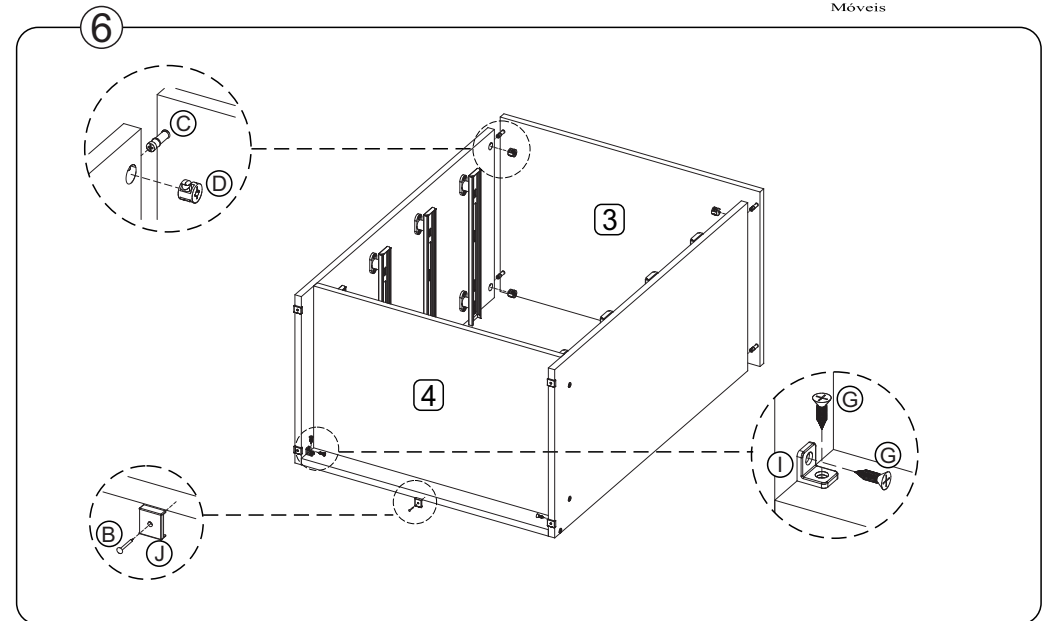
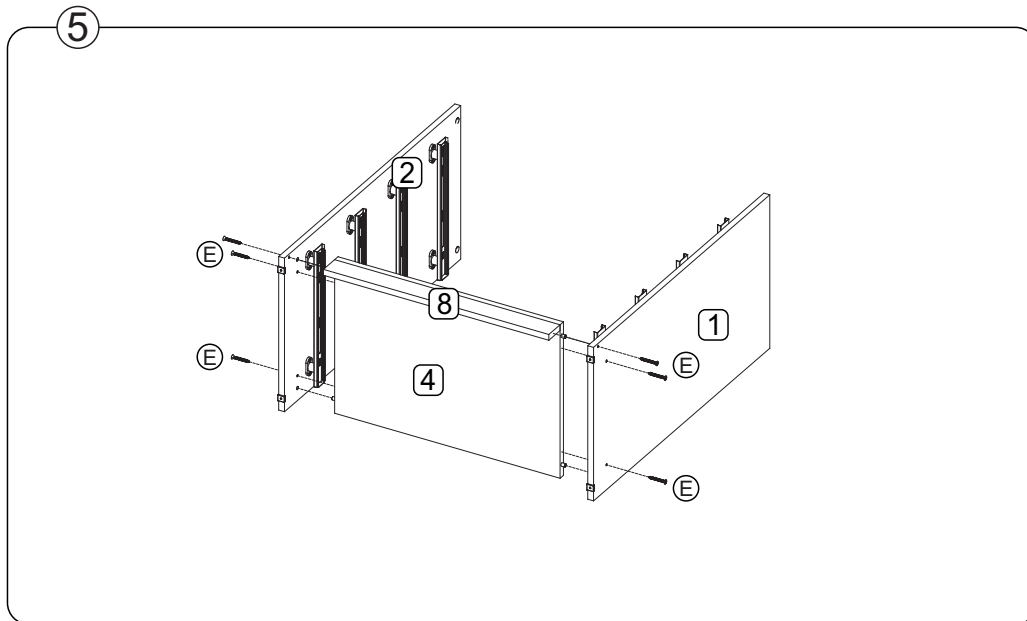

"IMPORTANTE LER COM ATENÇÃO E GUARDAR PARA EVENTUAIS CONSULTAS"